

# Are your machines installed in; out of reach, narrow, dark or high temperature locations?

Connecting the analog sensors (6 channels) and temperature sensors(2 channels), will allow you to immediately monitor a machine on the spot .

## Troubleresa II PLUS

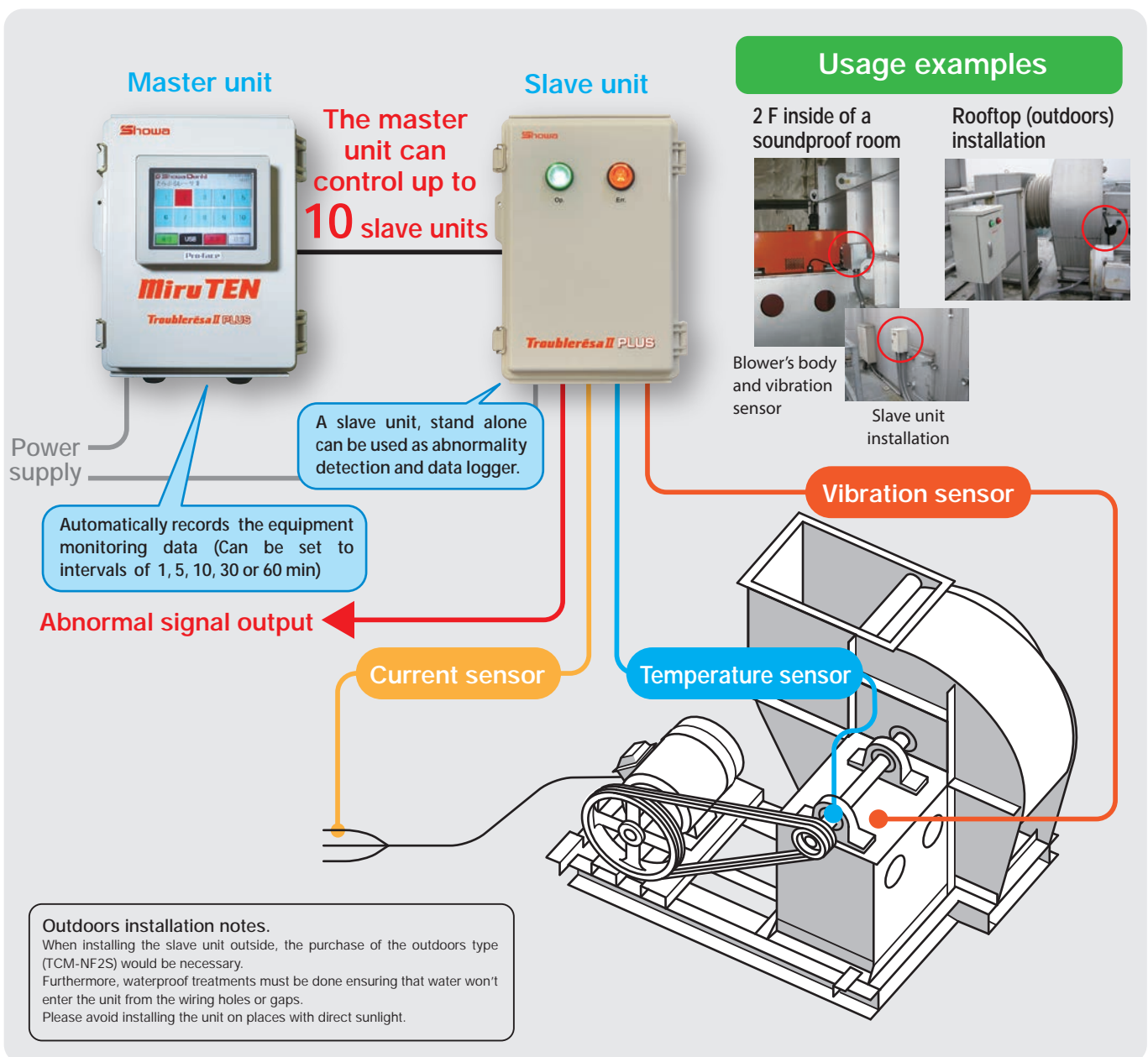





# Specification



## Slave unit

		Specifications	Notes
Model		TCM-NF2P	
Features		1. Data can be saved inside the slave unit • If using a single slave unit, the measured values from all the 8 channels can be stored on a CSV file inside the unit. (maximum 480 data unit, data will be stored on intervals of 30 min on a period of 10 days, once de 480 data unit will be reached the units would be replaced from the oldest one) • To extract the data from the slave unit, connect this one to a PC with a LAN cable, using Internet Explorer would allow you to see it. 2. E-mail sending function (optional) You can send an abnormality alarm mail to a total of 9 addresses (To·CC·BCC 3 of each) 3. Blinking red lamp • The red lamp will blink when an anomaly will be detected, making it easier to notice.	
Power supply	Voltage	AC100~240V 50/60Hz	Power supply cable not included
	Allowable voltage range	AC85~265V 47~63Hz	
	Power consumption	MAX 7W (36W)	The power consumption with sensors included is indicated between brackets ()
Input	Measurement points	8ch (6 switched 0-5V/4-20mA channels, 2 temperature channels)	
	Measurement range (accuracy)	0-5V: 2%FS (output ±0.1V)	
		4-20mA: 1.5%FS (output ±0.24mA)	
	Resolution	0-5V: 0.001V	
		4-20mA: 0.004mA	
	Sensor power supply	DC24V/MAX0.9A	The standard temperature sensor limit is set on a MAX of 150°C
Terminal shape	Terminal block	The total value is the value of the 6 channels	
Output points	External output contacts	2 no voltage form A connectors	
	Contact capacity	AC250V/DC30V 5A	
	Terminal shape	Terminal block	
Indicator light	Monitoring light	Green colour (lighted up while monitoring, in any other case will flash)	
	Abnormality detection light	Red colour	
Communication	Protocol	Modbus/TCP	
	Terminal	Ethernet (RJ-45)	
Environmental specification	Temperature	-10~+50°C	
	Humidity	10~90%RH (without condensation)	
	Ubication	Indoors	Special outdoor measures available
Casing	Material	ABS (Acrylonitrile butadiene styrene)	
	Dimension	D280xW190xH100mm (excluding protuberances)	
	Weight	1.5kg	

\*Please contact us for outdoors specifications



Miru Ten



Monitoring Software (coming soon)

## Master unit ( Miru Ten)

		Specifications	Notes
Model		FCM-BM2PT	
Features		• Up to 10 slave units can be connected. • The data saving intervals can be set to 1, 5, 10, 30 or 60 min. • 8 GB USB memory included (can store data for more than 10 years)	
Power supply	Voltage	AC100~240V 50/60Hz	
	Allowable voltage range	AC85~265V 50/60Hz	
Communication	Power consumption	MAX 10W	In case of communicating 10 slaves units.
	Protocol	Modbus/TCP	
Environmental specification	Terminal	Ethernet (RJ-45)	
	Temperature	0~50°C	
	Humidity	10~85%RH (without condensation)	
Casing	Location	Indoors	
	Material	ABS (Acrylonitrile butadiene styrene)	
	Dimension	D160xW220xH130mm (excluding protuberances)	
Output points	Weight	1.4kg	
Output points		2 no voltage connectors	

## Master unit monitoring software ( PC use)

		Specifications	Notes
Model		FCM-BM2P (monitoring software)	
Features		• Up to 100 slave units can be connected. • A PC with Windows OS is necessary (supports Windows 7, 8 and 10). • The data saving intervals can be set to 1, 5, 10, 30 or 60 min. • 9 data display units, another additional 5 units can be set up freely.	
Operating specifications	PC	Normal PC working on Windows OS. (not included)	
	OS	Windows*7 32bit/64bit (Enterprise, Ultimate, Professional, Home Premium, Starter) Windows*8 32bit/64bit (core, Pro, Enterprise) Windows*10 32bit/64bit	
	CPU	1.5GHz or more (1.5GHz min)	
	Free space on HDD	5GB (recommended)	
	Resolution	1280x768 or more (recommended)	
	Others	Microsoft.NET Framework4 Communication foundation: Ethernet port (LAN port) CD-ROM Reader (necessary for installation)	

\*The PC is not included and must be purchased by the customer

Optional parts	Specifications	Notes
Vibration sensor (VS-2502-□□, VS-V103-01)	Slave unit outdoors model	(TCM-NF25)
Temperature sensor (YYU4KM04B20A)	Slave unit wall mounting parts	(BFL-2G)
Current sensor (CTT-□□-CLS-CV-□□)	Magnet (to fix the vibration sensor)	(MG-01)
Mail transmitter (UNC-RP06A)		

Components to prepare by the customer LAN Cable (category 5e or more) •Generic USB Hub •Wireless LAN •Sensors •Wiring installation •Power cord

This product detects abnormalities caused on rotating machines, it doesn't count with countermeasures or fixing function. Furthermore abnormalities that can not be detected with this product may occur.

**SHOWA DENKI CO., LTD.**

Overseas Sales Dept.

1-25 Shinden Kita-machi, Daito-city, Osaka, Japan 574-0052

Tel: +81-72-871-1511 Fax: +81-72-870-7243

E-mail: web-info@showadenki.co.jp

showadenki

Search

